

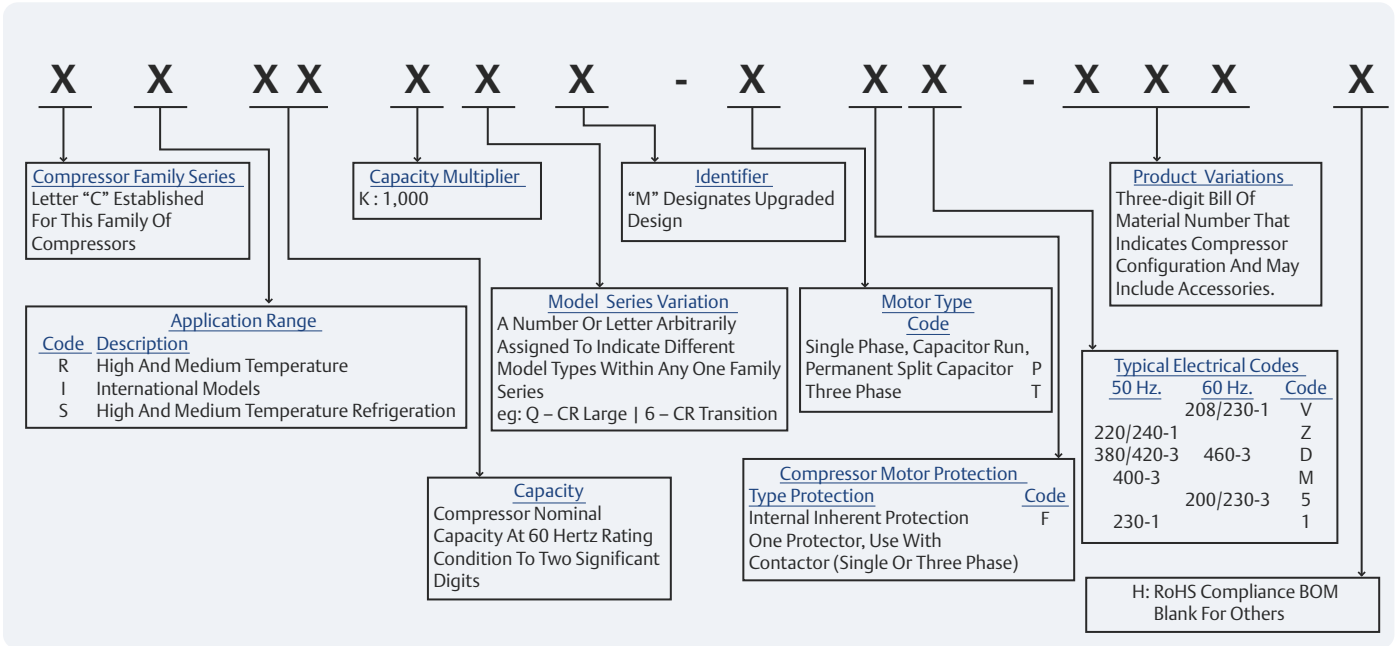

## Air-Conditioning Product Catalogue



## Nomenclature Details



Note : CR Models Are Available With RoHS Compliance, If Indicated At The Time Of Placing Purchase Orders.

Electrical accessories are not part of compressor BOM. Specified rating electrical accessories with compliance to specific country regulation shall be used.

## Mechanical Dimensions for CRK6M

SN	Compressor Model	View	Mount type	Dist 'A'			Suction Tube ID			Discharge Tube ID			
				inch	inch	mm	inch	inch	mm	inch	inch	mm	
1	CR20K6M-PFV	P	A	13.35	5/8	15.8	3/8	9.5					
2	CR20K6M-PFV	Q	E	13.35	5/8	15.8	3/8	9.5					
3	CR20K6M-PFV	R	D	13.35	5/8	15.8	3/8	9.5					
4	CR22K6M-PF1	P	A	13.35	5/8	15.8	3/8	9.5					
5	CR22K6M-PF1	Q	E	13.35	5/8	15.8	3/8	9.5					
6	CR22K6M-PF1	R	D	13.35	5/8	15.8	3/8	9.5					
7	CR22K6M-TFM	P	A	13.59	1/2	12.7	3/8	9.5					
8	CR24K6M-PFZ	P	A	13.35	5/8	15.8	3/8	9.5					
9	CR24K6M-PFZ	Q	E	13.35	5/8	15.8	3/8	9.5					
10	CR24K6M-PFZ	R	D	13.35	5/8	15.8	3/8	9.5					
11	CR24K6M-PFV	P	A	13.35	5/8	15.8	3/8	9.5					
12	CR24K6M-PFV	Q	E	13.35	5/8	15.8	3/8	9.5					
13	CR24K6M-PFV	R	D	13.35	5/8	15.8	3/8	9.5					
14	CR24K6M-TFD	P	A	13.59	5/8	15.8	3/8	9.5					
15	CR24K6M-TF5	P	A	13.59	5/8	15.8	3/8	9.5					
16	CR28K6M-PFV	P	A	14.11	3/4	19.1	3/8	9.5					
17	CR28K6M-PFV	Q	E	14.11	3/4	19.1	3/8	9.5					
18	CR28K6M-PFV	R	D	14.11	3/4	19.1	3/8	9.5					
19	CR30K6M-PF1	P	A	14.11	5/8	15.8	3/8	9.5					
20	CR30K6M-PF1	Q	E	14.11	5/8	15.8	3/8	9.5					
21	CR30K6M-PF1	R	D	14.11	5/8	15.8	3/8	9.5					
22	CR30K6M-TFM	P	A	13.59	5/8	15.8	3/8	9.5					
23	CR32K6M-PFZ	P	A	14.11	5/8	15.8	3/8	9.5					
24	CR32K6M-PFZ	Q	E	14.11	5/8	15.8	3/8	9.5					
25	CR32K6M-PFV	P	A	13.35	5/8	15.8	3/8	9.5					
26	CR32K6M-PFV	Q	E	13.35	5/8	15.8	3/8	9.5					
27	CR34K6M-PFZ	P	A	14.11	3/4	19.1	3/8	9.5					
28	CR34K6M-PFZ	Q	E	14.11	3/4	19.1	3/8	9.5					
29	CR34K6M-PFV	P	A	14.11	3/4	19.1	3/8	9.5					
30	CR34K6M-PFV	Q	E	14.11	3/4	19.1	3/8	9.5					
31	CR34K6M-TFD	P	A	13.59	3/4	19.1	3/8	9.5					
32	CR34K6M-TF5	P	A	13.59	3/4	19.1	3/8	9.5					
33	CR37K6M-PFZ	P	A	14.11	3/4	19.1	3/8	9.5					
34	CR37K6M-PFZ	Q	E	14.11	3/4	19.1	3/8	9.5					
35	CR37K6M-PFV	P	A	14.11	3/4	19.1	3/8	9.5					
36	CR37K6M-PFV	Q	E	14.11	3/4	19.1	3/8	9.5					
37	CR37K6M-TFD	P	A	14.00	3/4	19.1	3/8	9.5					
38	CR37K6M-TF5	P	A	14.00	3/4	19.1	3/8	9.5					

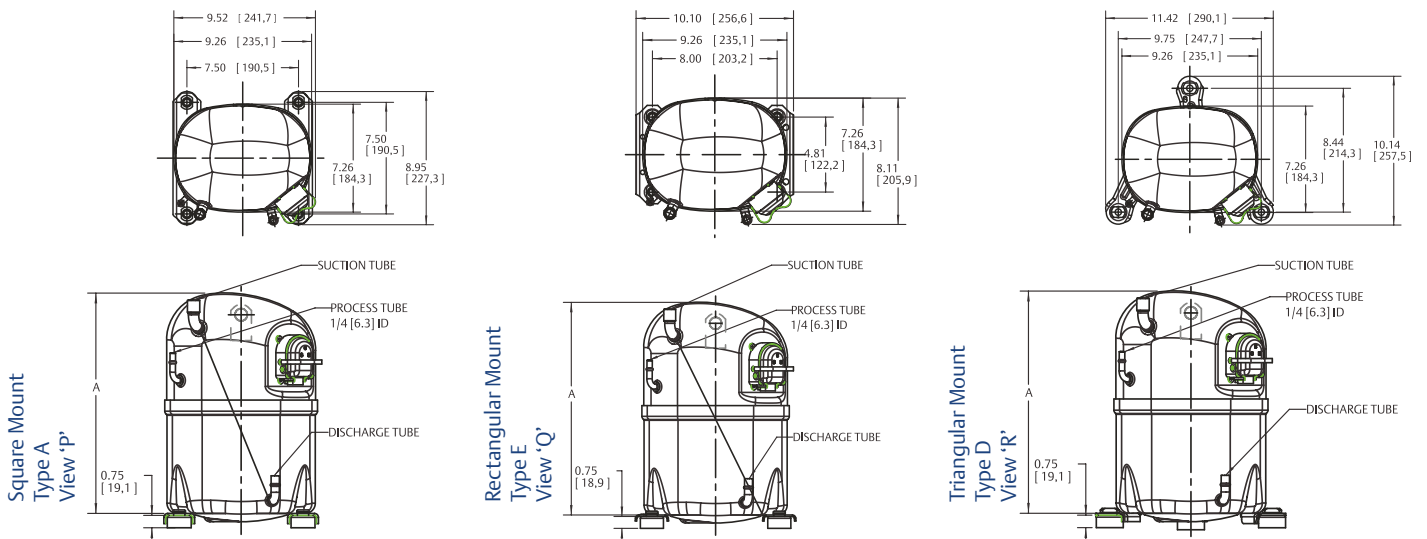

## HCFC-22 Compressor Specifications

Series	Frequency (Hz)	Compressor Model	Cooling Capacity* (Btu/hr)	Input Power (Watts)	EER*	Input Current (Amps)	LRA	Displacement (CC/Rev.)
CRK6M	50Hz	CR22K6M-PF1	18,500	1,750	10.6	7.8	54	40.80
		CR24K6M-PFZ	19,800	1,950	10.2	8.5	54	44.28
		CR24K6M-TFD	19,900	1,975	10.1	3.6	20	44.28
		CR30K6M-PF1	24,250	2,350	10.3	11.0	72	51.47
		CR32K6M-PFZ	27,200	2,720	10.0	13.4	85	57.70
		CR34K6M-PFZ	28,700	2,850	10.1	14.0	85	59.66
		CR34K6M-TFD	28,300	2,830	10.0	5.3	41	59.66
		CR36K6M-PFZ	29,300	2,720	10.8	13.6	85	56.65
		CR36K6M-TFM	29,100	2,680	10.9	4.9	41	59.66
		CR37K6M-TFD	31,200	3,000	10.4	5.6	45	63.52
		CR37K6M-PFZ	30,600	3,060	10.0	16.0	90	63.52
		CR42K6M-TFM	34,200	3,300	10.4	6.1	45	72.09
	CR42K6M-PFZ	34,400	3,300	10.4	15.4	104	72.08	
	60Hz	CR20K6M-PFV	20,000	2,000	10.0	8.5	60	39.35
		CR24K6M-PFV	23,900	2,350	10.2	10.3	60	44.28
		CR24K6M-TFD	23,900	2,300	10.4	3.5	24	44.28
		CR24K6M-TF5	23,300	2,300	10.1	6.8	55	44.28
		CR28K6M-PFV	28,500	2,650	10.8	12.0	80	49.62
		CR32K6M-PFV	32,200	3,280	9.8	15.4	88	57.70
		CR34K6M-PFV	34,300	3,385	10.1	15.8	88	59.66
		CR34K6M-TFD	33,800	3,300	10.2	5.1	45	59.66
		CR34K6M-TF5	33,900	3,300	10.3	10.0	65	59.66
		CR37K6M-PFV	36,800	3,680	10.0	16.8	86	63.52
		CR37K6M-TFD	37,200	3,580	10.4	5.6	45	63.52
CR37K6M-TF5		36,500	3,500	10.4	11.0	68	72.09	
CRKQM	50Hz	CR47KQM-PFZ	40,700	3,950	10.3	20.0	110	82.75
		CR47KQM-TFD	39,700	3,825	10.4	6.9	60	78.78
		CR53KQM-TFD	44,700	4,350	10.3	7.7	61	88.28
		CR57KQM-TFD	47,800	4,650	10.3	8.3	61	94.61
		CR62KQM-TFD	51,500	5,100	10.1	8.8	55	101.92
		CR47KQM-PFV	47,500	4,650	10.2	22.0	115	82.74
	60Hz	CR47KQM-TFD	47,200	4,550	10.4	6.8	51	78.78
		CR47KQM-TF5	45,700	4,420	10.3	13.5	125	78.78
		CR53KQM-TFD	53,000	5,200	10.2	7.5	60	88.28
		CR53KQM-TF5	52,500	5,050	10.4	15.5	135	88.28
		CR57KQM-TFD	57,000	5,550	10.3	8.1	60	94.61
		CR57KQM-TF5	56,500	5,540	10.2	16.2	135	94.61
		CR62KQM-PFV	60,600	6,200	9.8	28.5	155	101.92
		CR62KQM-TFD	61,300	6,075	10.1	8.7	50	101.92
		CR62KQM-TF5	61,300	6,100	10.0	17.5	125	101.92

Performance values declared at rating conditions are subject to +/- 5% tolerance

Rating Conditions	Evaporating Temperature °F/°C	Condensing Temperature °F/°C	Ambient Temperature °F/°C	Liquid Temperature °F/°C	Return Gas Temperature °F/°C
ARI	45/7.2	130/54.4	95/35	115/46.1	65/18.3

Voltage Rating # (V-Phase-Hz)	Weight (kg)	Motor Circuit	Run Capacitor	
			Mfd	VAC
230-1-50	29.8	PSC / CSCR	36	440
220/240-1-50	29.8	PSC / CSCR	36	440
380/420-3-50	29.5	3 Phase	NA	NA
230-1-50	32.5	PSC / CSCR	45	440
220/240-1-50	32.5	CSCR	45	440
220/240-1-50	32.5	CSCR	45	440
380/420-3-50	31.0	3 Phase	NA	NA
220/240-1-50	34.9	CSCR	45	440
400-3-50	31.0	3 Phase	NA	NA
380/420-3-50	32.0	3 Phase	NA	NA
220/240-1-50	34.9	CSCR	50	440
400-3-50	32.7	3 Phase	NA	NA
220/240-1-50	32.9	CSCR	60	440
208/230-1-60	29.8	PSC / CSCR	36	440
208/230-1-60	29.8	PSC / CSCR	36	440
460-3-60**	29.5	3 Phase	NA	NA
200/230-3-60	29.5	3 Phase	NA	NA
208/230-1-60	32.5	PSC / CSCR	45	440
208/230-1-60	29.8	CSCR	45	440
208/230-1-60	32.5	CSCR	45	440
460-3-60**	31.0	3 Phase	NA	NA
200/230-3-60	31.0	3 Phase	NA	NA
208/230-1-60	34.9	CSCR	50	440
460-3-60**	32.0	3 Phase	NA	NA
200/230-3-60	32.7	3 Phase	NA	NA
200/230-3-60	32.7	3 Phase	NA	NA
208/230-1-60	34.0	CSCR	40/45	440
220/240-1-50	36.0	CSCR	60	440
380/420-3-50	36.2	3 Phase	NA	NA
380/420-3-50	36.2	3 Phase	NA	NA
380/420-3-50	36.2	3 Phase	NA	NA
380/420-3-50	36.2	3 Phase	NA	NA
208/230-1-60	36.0	CSCR	60	440
460-3-60**	36.2	3 Phase	NA	NA
200/230-3-60	36.8	3 Phase	NA	NA
460-3-60**	36.2	3 Phase	NA	NA
200/230-3-60	36.8	3 Phase	NA	NA
460-3-60**	36.2	3 Phase	NA	NA
200/230-3-60	36.8	3 Phase	NA	NA
208/230-1-60	40.3	CSCR	60	440
460-3-60**	36.2	3 Phase	NA	NA
200/230-3-60	37.0	3 Phase	NA	NA

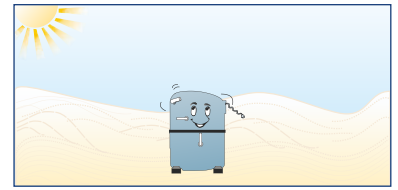

Best suited for 55°C  
High Ambient conditions



UL Approval##

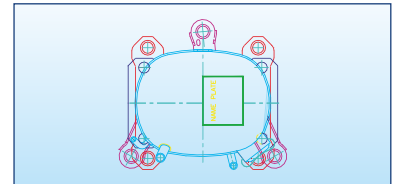

Multiple Choice Mounting

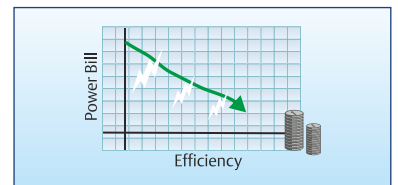

Ultra High Efficiency



High Liquid Handling Capability

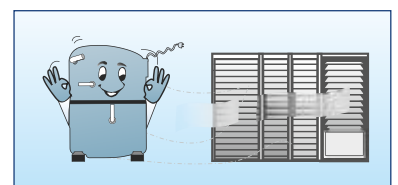

Industry Leading Reliability

Note: \*\* These TFD models are approved for 380/460-3-60 nominal voltage.  
Rated Load Amps & Locked Rotor Amps Shown above apply at 60Hz.  
\* Data is as per ARI Rating Standard  
## In progress for certain models.  
# For all models, operating voltage range is +/- 10% of the voltage rating specified above.  
CR 62 KQM - TFD for 380/460 - 3 - 60 has 350 - 506 V range.

Approval : UL & KC  
Cooling Type (CFM) - 400  
Oil Charge Qty - 1330CC (approx.)  
**Motor Circuit**  
PSC - Permanent Split Capacitor  
CSCR - Capacitor Start Capacitor Run

## Mechanical Dimensions for CRKQM/CRK6M

SN	Compressor Model	View	Dist 'A'		Suction Tube ID		Discharge Tube ID		Process Tube ID		SN	Compressor Model	View	Dist 'A'		Suction Tube ID		Discharge Tube ID		Process Tube ID	
			inch	mm	inch	mm	inch	mm	inch	mm				inch	mm	inch	mm	inch	mm	inch	mm
1	CR36K6M-PFZ-101	P	13.76	347.6	3/4	19.1	3/8	9.5	1/4	6.3	10	CR47KQM-TF5-201	Q	14.26	361.8	7/8	22.2	1/2	12.7	3/8	9.5
2	CR36K6M-TFM-101	P	13.51	342.8	3/4	19.1	3/8	9.5	1/4	6.3	11	CR53KQM-TFD-201	Q	14.26	361.8	7/8	22.2	1/2	12.7	3/8	9.5
3	CR42K6M-PFZ-101	P	14.26	361.8	3/4	19.1	3/8	9.5	3/8	9.5	12	CR53KQM-TF5-201	Q	14.26	361.8	7/8	22.2	1/2	12.7	3/8	9.5
4	CR42K6M-TF5-101	P	14.01	354.8	3/4	19.1	3/8	9.5	1/4	6.3	13	CR57KQM-TFD-201	Q	14.26	361.8	7/8	22.2	1/2	12.7	3/8	9.5
5	CR42K6M-PFV-101	P	14.01	354.8	3/4	19.1	1/2	12.7	1/4	6.3	14	CR57KQM-TF5-201	Q	14.26	361.8	7/8	22.2	1/2	12.7	3/8	9.5
6	CR42K6M-TFM-101	P	14.01	354.8	3/4	19.1	3/8	9.5	1/4	6.3	15	CR62KQM-PFV-201	Q	15.01	380.8	7/8	22.2	1/2	12.7	3/8	9.5
7	CR47KQM-PFZ-101	P	14.26	361.8	7/8	22.2	1/2	12.7	3/8	9.5	16	CR62KQM-TFD-201	Q	14.26	361.8	7/8	22.2	1/2	12.7	3/8	9.5
8	CR47KQM-PFV-101	P	14.26	361.8	7/8	22.2	1/2	12.7	3/8	9.5	17	CR62KQM-TF5-201	Q	14.26	361.8	7/8	22.2	1/2	12.7	3/8	9.5
9	CR47KQM-TFD-201	Q	14.26	361.8	7/8	22.2	1/2	12.7	3/8	9.5											

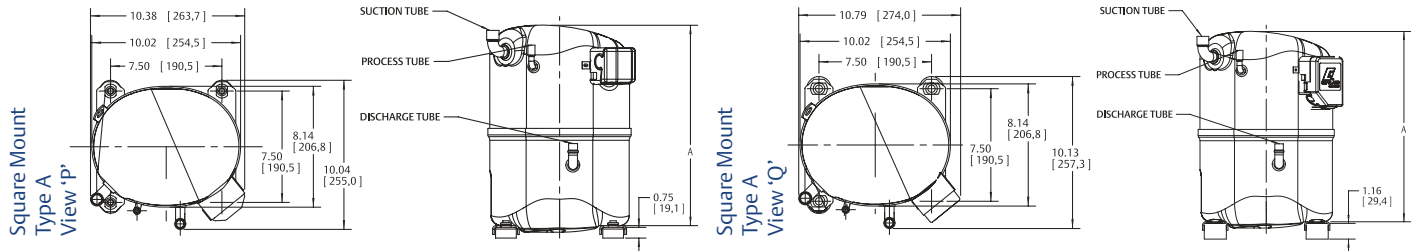

## Bill of Material Nomenclature

1 <sup>st</sup> Digit	Compressor Mounting				Mounting Kit		Terminal Fence	
	A (Long Leg)	E (Short Leg)	D (3 Leg)	Other***	Std**	Other***	Half Round- CR20- CR37 Square - CR 36/42 PFV/PFZ/TFM & CR 47 PFZ/PFV)	Rectangular
1	X				X		X	
2	X				X			X
3		X			X		X	
4			X		X		X	
5		X				X	X	
6				X		X	X	
2 <sup>nd</sup> Digit	Suction				Discharge		Process	
	Tube Upward	Tube Angular	Tube Straight		Tube		Tube Upward	Other***
0	X				X		X	
1		X			X		X	
2		X			X			X
3 <sup>rd</sup> Digit	Crank Case Heater							
	No Heater	240V	480V					
1	X							
2		X						
3			X					

\*\*\* Indicates Non Standard Requirements & shall be suffixed by two digits at the end. XX  
 \*\* Standard Mounting Kit & Fence Design may vary for different Platform / Designs.

## Model Availability

Displacement/ Electrical	PFV	TF5	PF1	PFZ	TFM	TFD
CR20	101,102,301,401					
CR22			101,111		101,111	
CR24	101,102,301,401	101,102		101,102,301		101,102,103
CR28	101,102,301,401					
CR30			101,102,111,112,401,301		101,102,111,112	
CR32	101,102,301			101,102,301		
CR34	101,102	101,102		101,102		101,102,103
CR36				101,102,111,112	101,102,103,111,112, 113	
CR37	101,102	101,102		101,102		101,102,103
CR42	101,102	101,102		101,102	101,102,103	
CR47	101,102	201,202		101,102		201,202,203
CR53		201,202				201,202,203
CR57		201,202				201,202,203
CR62	201,202	201,202				201,202,203

## Emerson Climate Technologies at a glance

Emerson Climate Technologies is the world's leading provider of heating, ventilation, air conditioning and refrigeration solutions for residential, industrial and commercial applications. We combine technically superior products and services from our industry-leading

divisions and brands with our global engineering, design and distribution capabilities to create reliable, energy efficient climate systems that improve human comfort, safeguard food, and protect the environment.

CACRCOM-0711

As we are constantly endeavouring to improve the performance of our models, the specifications mentioned here are subject to change from time to time. The Emerson logo is a trademark and service mark of Emerson Electric Co.

---

**For more details, see [www.EmersonClimate.com](http://www.EmersonClimate.com)**

Emerson and Copeland are trademarks of Emerson Electric Co. or one of its affiliated companies. ©2011 Emerson Electric Co. All rights reserved. Information contained in this brochure is subject to change without notification.