

Wiring Diagram

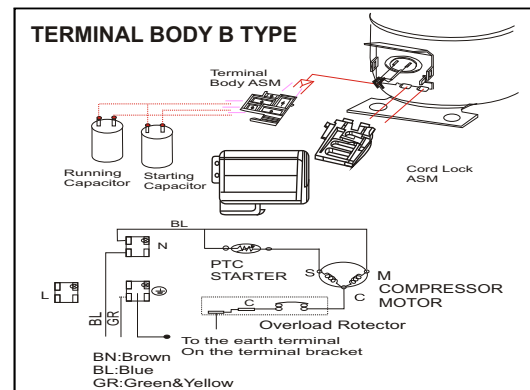
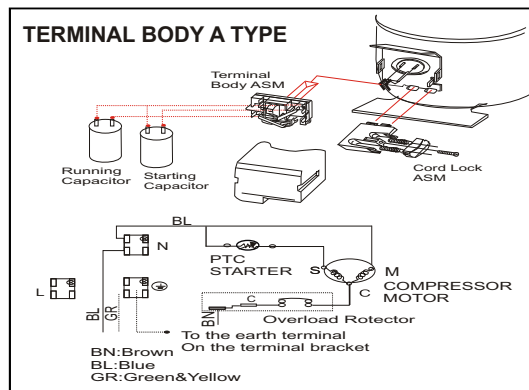
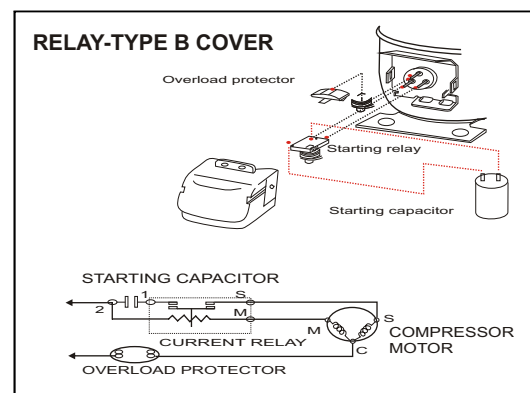
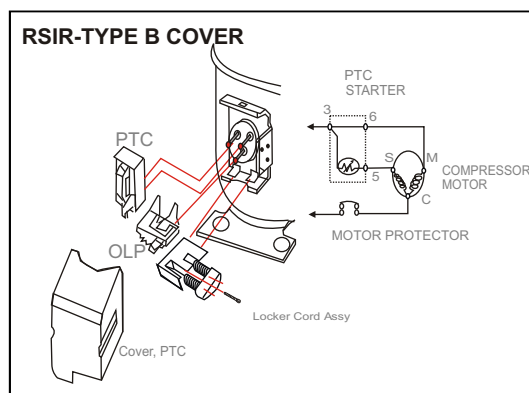
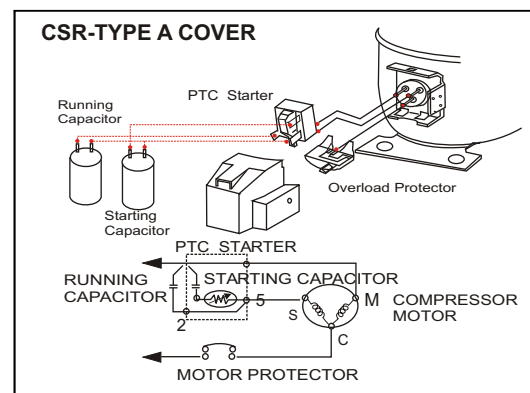
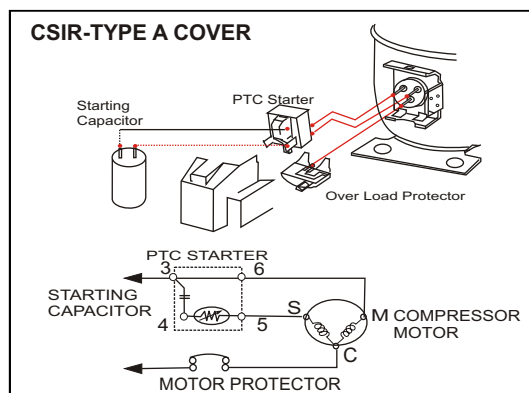
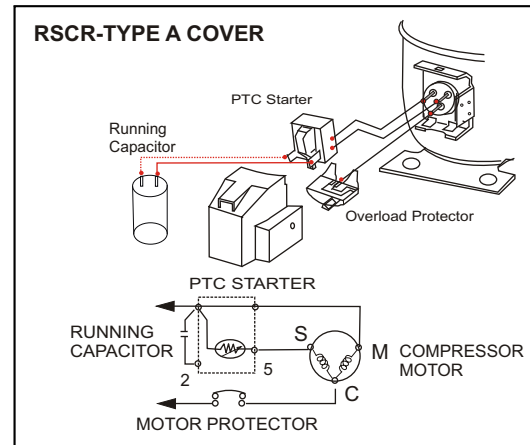
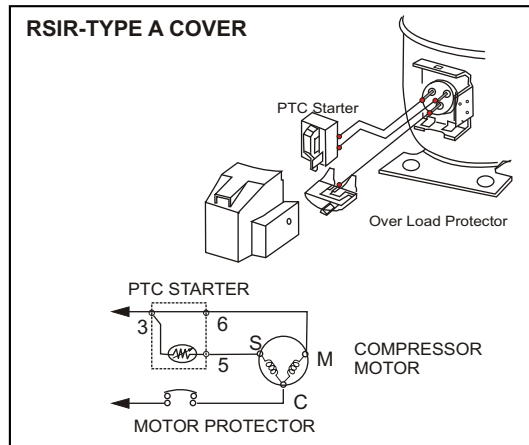

N.B: In Order to continuously improve our product, the specs. mentioned in the catalogue may change without prior information.

LG Electronics India Pvt. Ltd.
Plot No-51, Udyog Vihar, Surajpur – Kasna Road,
Greater Noida (U.P) Pin-201306.
Ph: (+91) 0120-2560900/940 Ext:372 Fax:(+91)0120-2560921

LGE Head Quarters, Korea
LG twin Tower, Yoido-Dong, Yongdungpo-Gu,
Seoul,150-721, Korea
TEL : +82-2-3777-7830-8
FAX : +82-2-3777-5346

LGE Changwon Plant, Korea
391-2, Gaeumjung-dong,
Changwon-city, Gyeongnam, 641
TEL : +82-55-260-3574-5
FAX : +82-55-260-3504

LG Electronics India Pvt Ltd
www.lgindia.com

Rev .02/01-04-2010



LG REFRIGERATION COMPRESSOR



Performance Data Sheet: R134a Hi-EER Compressors - LBP



Type	Voltage (V) & Frequency(Hz)	Refrigerant	Model	Displacement (CC)	PERFORMANCE (ASHRAE -23.3°C/54.4°C @ 50 Hz)						PERFORMANCE (CECOMAF -25°C/55°C @ 50 Hz)					
					Cooling Capacity			Input Power (W)	COP W/W	EER Btu/Wh	Cooling Capacity			Input Power (W)	COP W/W	EER Btu/Wh
					kcal/h	W	Btu/h				kcal/h	W	Btu/h			
MA	220-240 50Hz	R134a	MA53LAEM	5.3	140	162	556	104	1.6	5.3	-	-	-	-	-	-
			MA57LBJM	5.7	145	168	576	109	1.5	5.3	-	-	-	-	-	-
			MA57LCJM	5.7	145	168	576	109	1.5	5.3	-	-	-	-	-	-
MC	220-240 50Hz	R134a	MC53LAEM	5.3	139	161	522	105	1.5	5.3	-	-	-	-	-	-
			MC57LAEM	5.7	147	171	584	106	1.6	5.5	-	-	-	-	-	-
			MC62LAEH*	6.2	153	177	607	112	1.6	5.4	-	-	-	-	-	-
MQ	220-240 / 50Hz	R134a	MQ57LAEH*	5.7	143	166	568	100	1.7	5.7	-	-	-	-	-	-
			MQ45LAJM*	4.5	105	122	417	93	1.3	4.5	-	-	-	-	-	-

* Under Development

Electrical Specification: R134a Hi-EER Compressors - LBP



Type	Voltage (V) & Frequency(Hz)	Refrigerant	Model	Motor Type	ELECTRICAL PARTS				OIL		Cooling Type	Net Weight (kg)
					Starting Device (PTC)	Motor Protector (OLP)	Capacitor		Viscosity (cSt)	Qty (cc)		
							Starting (µF/ Surge Voltage)	Running (µF/ Surge Voltage)				
MA	220-240 50Hz	R134a	MA53LAEM	RSCR-PTC	QP2-33MD2	4TM158RFB	-	5/400	22	220	ST	8.2
			MA57LBJM	RSCR-PTC	QP2-33MD2	4TM158RFB	-	5/400	22	220	ST	9.1
			MA57LCJM	RSCR-PTC	QP2-33MD2	4TM158RFB	-	5/400	22	220	ST	9.1
MC	220-240 50Hz	R134a	MC53LAEM	RSCR-PTC	QP2-33MD2	4TM158RFB	-	5/400	10	220	ST	9.5
			MC57LAEM	RSCR-PTC	QP2-33MD2	4TM158RFB	-	5/400	10	220	ST	9.5
			MC62LAEH*	CSR-PTC	P330MB	4TM174TFB	30/300	5/400	10	220	ST	9.5
MQ	220-240 / 50Hz	R134a	MQ57LAEH*	CSR-PTC	EPTC-33	DRB17R61A1	30/300	5/400	10	220	ST	9.5
			MQ45LAJM*	RSCR-PTC	P330MD	4TM174TFB	-	5/400	10	220	ST	8.2

* Under Development

Performance Data Sheet: R600a Hi-EER Compressors - LBP

Type	Voltage (V) & Frequency(Hz)	Refrigerant	Model	Displacement (CC)	PERFORMANCE (ASHRAE -23.3°C/54.4°C @ 50 Hz)						PERFORMANCE (CECOMAF -25°C/55°C @ 50 Hz)					
					Cooling Capacity			Input Power (W)	COP W/W	EER Btu/Wh	Cooling Capacity			Input Power (W)	COP W/W	EER Btu/Wh
					kcal/h	W	Btu/h				kcal/h	W	Btu/h			
MQ	220-50Hz	R600a	MQ98NAJH*	9.8	152	176	603	101	1.7	6.0	114	132	453	98	1.3	4.6
			MQ88NAJM*	9.0	145	168	576	95	1.8	6.1	109	126	432	92	1.4	4.7
			MQ98NAEM*	9.8	152	176	603	96	1.8	6.3	114	132	453	93	1.4	4.9

* Under Development

Electrical Specification: R600a Hi-EER Compressors - LBP

Type	Voltage (V) & Frequency(Hz)	Refrigerant	Model	Motor Type	ELECTRICAL PARTS				OIL		Cooling Type	Net Weight (kg)
					Starting Device (PTC)	Motor Protector (OLP)	Capacitor		Viscosity (cSt)	Qty (cc)		
							Starting (µF/ Surge Voltage)	Running (µF/ Surge Voltage)				
MQ	220-50Hz	R600a	MQ98NAJH*	CSR-PTC	P330MB	4TM149NFB	30/300	5/400	10	220	ST	9.5
			MQ88NAJM	RSCR-PTC	QP2-33MD2	4TM149NFB	-	5/400	10	220	ST	9.5
			MQ98NAEM*	RSCR-PTC	QP2-33MD2	4TM149NFB	-	5/400	10	220	ST	9.5

* Under Development

Evaporating Temperature Range

Evaporating Temperature Range		
MA,MC,MQ	LBP	HBP
		-30 to -5°C

Test Conditions - CECOMAF

Ambient Temperature	Evaporating Temperature	Condensing Temperature	Sub cooled Liquid Temp Expansion Device	Suction Gas Temperature	Suction Pressure		Discharge Pressure	
					R600a		R600a	
C°	C°	C°	C°	C°	kg/cm²(g)	Psi (g)	kg/cm²(g)	Psi (g)
LBP								
32	-25	55	55	32	-0.43	-6.11	6.78	96.4
HBP								
32	5	55	55	32	0.23	3.27	6.78	96.4

Compressor Nomenclature



MA 69 L A E G

Series name

MA
MC
MQ

Displacement

Ex) 69 = 6.9cc/rev.

Application category

L : R134a, LBP
H : R134a, HBP
N : R600a, LBP

Improvement order

A
B
C
D

Motor type

G : RSIR, PTC
F : CSIR, PTC
M : RSCR, PTC
H : CSR, PTC
P : CSIR, RELAY

Rated voltage & Frequency

A : 110V 50/60Hz P : 110V 50Hz
B : 220V 50/60Hz Q : 110-115V 60Hz
C : 115V 60Hz S : 200-220V 50Hz
D : 220V 60Hz T : 220-240V 50Hz
E : 220-240V 50Hz U : 110-127V 60Hz
F : 127V 60Hz 220V 60Hz
J : 220V 50Hz
K : 110V 60Hz

Application

Low Back pressure (LBP)

- Deep freezer
- Refrigerator
- Ice cube Machine
- Laboratory Appliance

High Back pressure (HBP)

- Water Cooler
- Panel Cooler
- Water Chiller
- Refrigerated Air Dryer
- Milk Cooler

Mounting Details (MA/MC/MQ Series)

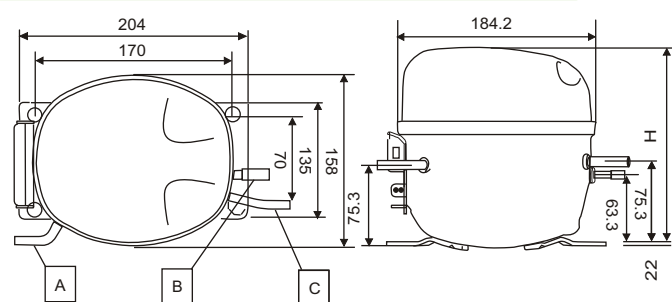

Oil Cooling Pipe Details

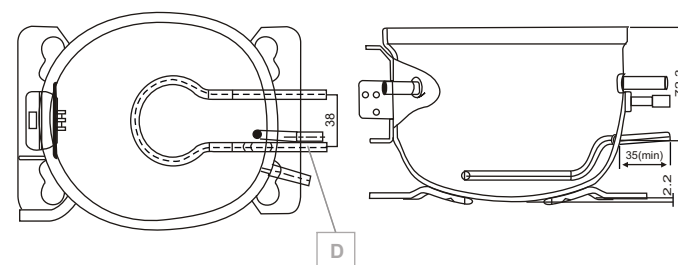

Series	H mm	Suction		Discharge		Process		Oil Cooling	
		ID (mm)	T(mm)	ID(mm)	T(mm)	ID(mm)	T(mm)	ID(mm)	T(mm)
MA42/45/53	172	6.54	0.7	5	0.85	6.54	0.7	NA	NA
MA57/62/69/72/88	180	6.54	0.7	5	0.85	6.54	0.7	4.95	0.7
MC53/57/62 MQ88/98	180	6.54	0.7	5	0.85	6.54	0.7	NA	NA

Mounting Bracket



Type A

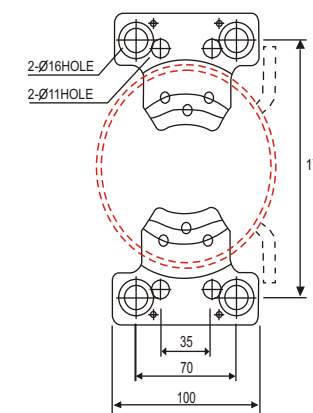

Type B

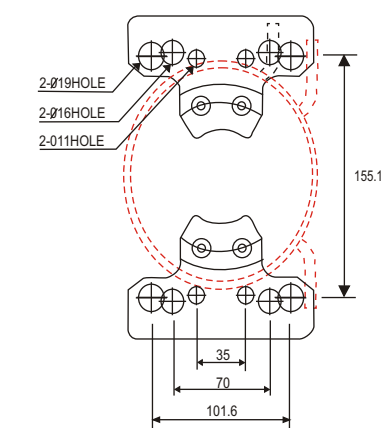

Terminal Protector

Type A

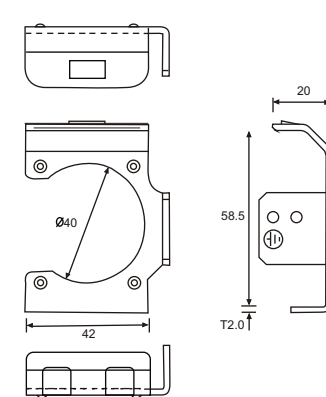

Type B

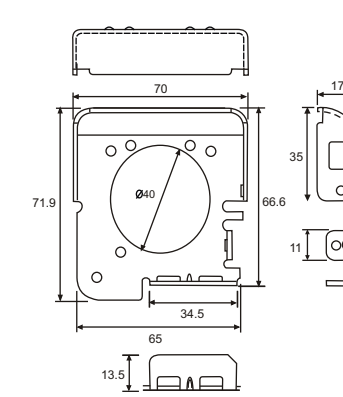

Type C

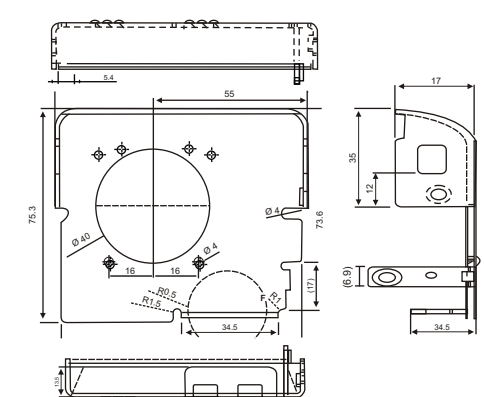

Mounting Accessories

Type	Grommet	Sleeve Bolt
4A (10) type 		
5A type 		
7A type 		
4A snap on type 		